

APPLICATION FORM



CLOSING DATE

EXHIBITOR

30. 4. 2010

23. - 27. 11. 2010

This order send to: Progres Partners Advertising, s. r. o, Opletalova 55, CZ-110 00 Praha 1
tel.: +420/224 234 274, 224 218 403, fax: +420/224 235 033, 224 218 312, e-mail: aqua@ppa.cz

EXHIBITOR

Full Company Name:
Address:
..... VAT No:
Phone: Fax:
Contact person: Tel.: Fax:
Contact e-mail:
Director:
Address for correspondence (only if address does not correspond with a registered office of a company):

AGENCY providing all aspects of trade fair participation for the exhibitor including payment for the provided services

Full Company Name:
Address:
Contact person: Tel.: Fax:

REGISTRATION FEE - Each exhibitor and co-exhibitor, after receiving this application by organiser, will be charged for a registration fee of CZK 6000 plus 20% VAT on which will be made out an invoice. The registration fee includes entry in our catalogue, on the trade fair's website, and on the site map for visitors' guidance (distributed along with each ticket), and in all other materials that mention our exhibitors. After the receipt of the application by the organiser, the company becomes an exhibitor according to the general conditions for participation at the trade fair AQUA-THERM Praha.

PRODUCT GROUPS

- | | | |
|---|---|---|
| <input type="checkbox"/> Heating | <input type="checkbox"/> Medical equipment and fittings | <input type="checkbox"/> Project work |
| <input type="checkbox"/> Pipes and pipe fittings for heating, water, drainage, gas and steam | <input type="checkbox"/> Measuring, management and control | <input type="checkbox"/> Installation and maintenance |
| <input type="checkbox"/> Ventilation equipment, air-conditioning and protection of atmosphere | <input type="checkbox"/> Equipment for generation of electricity | <input type="checkbox"/> Wholesalers and vendors |
| <input type="checkbox"/> Cooling | <input type="checkbox"/> Thermal insulation | <input type="checkbox"/> Operation, inspections, audits |
| | <input type="checkbox"/> Tools and aids | <input type="checkbox"/> Facility Management |
| | <input type="checkbox"/> Consultation, audits, financing, education | <input type="checkbox"/> Other services |

SPACE REQUIREMENTS

Base prices: Row space Corner space from 24 sqm Front space from 50 sqm Island space from 100 sqm Open area

sqm CZK 3950/sqm CZK 4250/sqm CZK 4350/sqm CZK 4450/sqm CZK 1900/sqm

Double storey stand - upper space: + 50% of space rental.

We intend to build a two-storey stand: yes sqm no

Detailed space requirements:

I request invoicing in CZK EUR

For the conversion of prices into EUR will be used the ČSOB's exchange rate valid on the last working day of the calendar month preceding the date on which the first advance invoice is issued.

Bank details for the payment:

Bank: CSOB,a.s.
BIC(SWIFT): CEKOCZPP
Account No in CZK: 0400081583/0300
IBAN: CZ620300000000400081583
Account No in EUR: 08158280/0300
IBAN: CZ6803001712800400081583

Applications sent by April 30th will be granted with 10% reduction from the base prices (when the payment for the registration fee was received). The base prices remain valid until May 31st 2010, then will be increased 10% for the applications received after this date.

• We agree without reserve with the conditions listed on the reverse side of the application form and the price conditions of the fair. • We respect organizer's right to enlarge or reduce adequately the demanded exposition site and to place the exposition according to the professional division of the fair into individual pavilions (halls). The application shall not be accepted if activity of the company is not in accordance with the fair nomenclature. • The application is invalid without the signature, stamp, date and place.

.....
Place and date

.....
Company stamp and legally binding signature

Terms of participation for exhibitors AQUA-THERM Praha

Article I

Event Organizer

Progres Partners Advertising, Co. Ltd., Opletalova 55, CZ - 110 00 Prague 1 (hereinafter the "Organizer")

Article II

Applications and site allocation

1) Application for the participation is binding for the exhibitor.

Organizer decides about the application acceptance, shortening or refusal without being obliged to explain his decision.

2) The certificate of the final site allocation is provided by Organizer simultaneously with the invoice of the site location. The rent must be reimbursed by the date given in the invoice. The reimbursement of the whole rent is a condition of the exhibition site delivery to the Exhibitor before the installation opening.

3) In case the rent is not reimbursed by the Exhibitor by the date given in the invoice, this delay is regarded as an important breach of contract and the Organizer has right to resign from the Contract. In this case the organiser does not refund the registration fee.

4) The Exhibitor undertakes to observe the obligation resulting from his and his co-exhibitors' participation or the participation of the companies entrusted by him to provide the construction of the stalls or the exhibits supply. The possible change is a subject to prior approval by the Organizer.

5) The Organizer reserves the right to change - as an exception - the location or size of the exhibition area even after it has been assigned to an exhibitor.

6) The price for an area in the application form includes the renting of the area, the services associated therewith (heating, lighting of the hall etc.) and participation at a social evening, promotion of event.

Article III

Rent and exhibition sites

1) The rent of exhibition sites is always listed in the application form or in the Organizer's letter. Each started meter is charged as a total. The smallest allocated area is 9 sqm.

2) The allocated exhibition site must not be conveyed by the Exhibitor to the third party without prior approval of the Organizer.

3) If the Exhibitor cancels his participation in the fair, his registration fee is not returned. If cancellation is made by the exhibitor after the assignment of exhibition space, the exhibitor will be charged a cancellation fee in the amount of 100% of the rent. The exhibitor is required to remit this amount immediately.

Article IV

Terms of payment

The Exhibitor undertakes to pay to the Organizer all the provided performances by the date of the invoice maturity.

Article V

Exhibits

1) "Exhibit" means a product, goods or intangible right being obligatorily registered and exhibited on the site assessed by the Organizer and accordant with the nomenclature of the action.

2) It is forbidden to list the prices of the exhibits. The Exhibitor must secure the exhibits against the robbery.

3) The transport of the goods (exhibits) out and in is provided according to the directions of the Organizer. The Exhibitor is obliged to send free stool for all installation material and exhibits for the fairs and exhibitions. Manipulation and warehouse charges are charged for the exhibits and installation material that has not been removed by the final term of the site location.

4) The reception of the products and goods (exhibits) is provided exclusively by the Exhibitor. In case the Exhibitor nor his representative are not present, the exhibit shall be unloaded at the allocated site at the risk of the Exhibitor. It is not allowed to transport the exhibits away during the event.

Article VI

Expositions construction and installation, exhibits assembly

1) The terms of the installation, dismantling and operation time is determined by the Organizer. The exception from the term is provided by the Convener on the Exhibitor's or his assignee's request. The Exhibitor or his assignee shall reimburse the costs resulting from the above mentioned. Technical-safety precautions and Organizer's Organisation instructions are binding for the Exhibitor during the construction of the exposition. In case these are not observed the Organizer has right to forbid the running of the stands.

2) The official Contractor for the expositions construction is Progres Partners Advertising, Co. Ltd.

When realizing an exhibit through unofficial contractors, the exhibitor is fully responsible for his activities on the presenter's premises, and particularly is to secure work safety and to abide by the schedule for

the assembly and disassembly of exhibits. These terms are included in the Organizer's Organisation instructions.

3) Wall hydrants, fire extinguishers and other devices assuring the security must not be overbuilt. Any interference to the pavilions or vacant areas are strictly forbidden.

4) The maximum height of the expositions is 3 meters. The exceptions must be approved by the Organizer.

5) In case the Exhibitor exceeds with his expositions the height of 3 meters is obliged to provide to the Organizer (enough in advance) before the installation the technical project in the ground-plan and front view for the approval. He must demonstrate this approval at the receipt of the allocated exhibition site. Architectural form and running of the exposition must not interfere with the function of neighbouring expositions. The area of the rented area must not be exceeded even above the ceiling construction. For stands with more than one storey it is necessary to present a stress analysis calculation along with the project.

6) The Exhibitor is obliged to order at the Organizer the water, electric and telecommunication supplies.

7) The Exhibitor is responsible for all devices loaned by the Organizer and is obliged to render these undamaged after the event termination.

8) Every damage of the exhibition site and Organizer's devices and Exhibition Centre must be rendered by the Exhibitor to the original state on his own costs or reimbursed.

9) The Exhibitor must not eliminate the exposition before the termination of the event.

10) During the dismantling of the stands, the exhibitor (implementing firm) is liable to ensure that all material (wood, chipboard, carpets etc.) is removed from the grounds of the Exhibition Ground. It is only possible to put small-scale waste in the rubbish bins. The organiser can ensure the disposal of unwanted materials from stands upon request for a fee.

Article VII

Promotion, advertising, logos and catalogue

1) The Exhibitor has right to promote his products only within his own exposition.

2) All manners of exhibiting at his own exhibition site or elsewhere (for example the machines at work, movies, music productions, fashion shows, etc.) must be approved by the Organizer who has right to limit (even after previous approval) or forbid the demonstrations producing noise, dustiness, shaking or otherwise limits or interferes to the fair running. The acoustic advertisements may be used only after the previous written approval by the Organizer. Exhibitors who use pre-recorded music at their stands must abide by the provisions of act No. 237/1995 Coll., on Collective Copyright Management. Each exhibitor is individually responsible for the administrative and billing aspects of royalties and for their payment to the competent Authors' Associations. It is strictly forbidden to transport the displays, distribute the leaflets, stick promotional and information materials outside the exhibition site (on the windows, walls, floors or columns of pavilions).

The Organizer has right to eliminate at the costs of Exhibitor all promotional materials that does not suit the above listed conditions.

3) The Exhibitor has right to be listed in the fair catalogue released by the Organizer. He may indicate there his address and 10 expressions for the nomenclature listed in his application. Any further presentation must be reimbursed.

Article VIII

Insurance

The Organizer is not responsible for the lost, demolition or any damage of exhibits, equipment, stand, goods, packages and packaging materials belonging to the Exhibitor or his co-exhibitors, irrespective of whether this damage appeared before, during or after the fair. The exhibitor shall take out insurance for this purpose.

Article IX

Final arrangements

1) In case the Organizer is not able to start the fair, to provide the running of the event in its whole duration or in its part at the whole area of the Exhibition Centre or its part because of the uncaused circumstances ("vis major"), he must immediately inform the Exhibitor. All obligations resulting from the contract about the Exhibitor's participation expire. In the case the Exhibitor has no right for the damage compensation. The Organizer has right to retain an appropriate part of the payments reimbursed by that time by the Exhibitor.

2) The Exhibitor may put in a claim for the works and services provided by the event Organizer at the responsible employee. This must be done within 48 hours before the termination of the fair, otherwise this right expires.

3) If not determined otherwise, the Organizer has right in case of the violation of any of the above listed stipulations to exclude the Exhibitor from the participation at the fair or other event.

OBLIGATORY ENTRY INTO THE CATALOGUE



CLOSING DATE

EXHIBITOR

30. 4. 2010

23. - 27. 11. 2010

*This entry send to: Progres Partners Advertising, s. r. o, Opletalova 55, CZ-110 00 Praha 1
tel.: +420/224 234 274, 224 218 403, fax: +420/224 235 033, 224 218 312, e-mail: aqua@ppa.cz*

EXHIBITOR - OBLIGATORY ENTRY INTO THE CATALOGUE

Each exhibitor is mentioned both in the Exhibitors' Directory and according to branches.

Company:

Address:

.....

Phone: Fax:

E-mail: http://

Text (please fill in block capitals):

.....

.....

.....

Please select the articles according to the list backside to be entered in the exhibitor's catalogue. **10 items max.**

In the Exhibitors' Directory put us under the letter:

COMPANIES AND BRANDS REPRESENTED:

.....

.....

CO-EXHIBITOR - OBLIGATORY ENTRY INTO THE CATALOGUE

Each co-exhibitor is mentioned both in the Exhibitors' Directory and according to branches.

Company:

Address:

.....

Phone: Fax:

E-mail: http://

Text (please fill in block capitals):

.....

.....

.....

Copy the backside and select the articles of the co-exhibitor according to the list to be entered in the exhibitor's catalogue. **10 items max.**

In the Exhibitors' Directory put us under the letter:

.....
Place and date

.....
Company stamp and legally binding signature

of exhibitor*):

of co-exhibitor*):

*): delete as appropriate

HEATING

- 1.1 Boilers and burners**
 - 1.1.1 Hot-water gas boilers
 - 1.1.2 Hot-water oil boilers
 - 1.1.3 Hot-water boilers for wood and biomass
 - 1.1.4 Hot-water coal boilers
 - 1.1.5 Hot-water electric boilers
 - 1.1.6 Hot-water boilers
 - 1.1.7 Steam boilers
 - 1.1.8 Other boilers
 - 1.1.9 Gas burners
 - 1.1.10 Oil burners
 - 1.1.11 Other burners
- 1.2 Other heat sources**
 - 1.2.1 Local gas heaters
 - 1.2.2 Gas radiant heaters
 - 1.2.3 Electric storage heaters
 - 1.2.4 Hot-air units
 - 1.2.5 Fireplaces, hearthstone
 - 1.2.6 Stoves, cookers and other local heaters
 - 1.2.7 Heat accumulators
- 1.3 Renewable and alternative sources of heat**
 - 1.3.1 Solar collectors
 - 1.3.2 Heat pumps
 - 1.3.3 Cogeneration units
- 1.4 Heat exchangers for heating**
- 1.5 Transfer stations**
- 1.6 Chimneys and flues**
- 1.7 Fuel management**
 - 1.7.1 Propane - butane
 - 1.7.2 Heating oil
 - 1.7.3 Liquid natural gas
 - 1.7.4 Solid fuels
- 1.8 Heating surfaces (bodies, floor and wall heating systems)**
 - 1.8.1 Plate heating bodies
 - 1.8.2 Steel radiators
 - 1.8.3 Cast-iron radiators
 - 1.8.4 Aluminium radiators
 - 1.8.5 Tube radiators
 - 1.8.6 Bathroom tube radiators
 - 1.8.7 Convectors
 - 1.8.8 Electric direct heaters
 - 1.8.9 Radiation panels and bands
 - 1.8.10 Hot water underfloor heating
 - 1.8.11 Electric underfloor heating
 - 1.8.12 Wall heating
- 1.9 Safety equipment for heating**
 - 1.9.1 Expansion cylinders
 - 1.9.2 Replenishment and expansion sets
- 1.10 Pumps, compressors, turbochargers**
 - 1.10.1 Circulation pumps
 - 1.10.2 Pressure pumps
 - 1.10.3 Compressors
 - 1.10.4 Turbochargers
- 1.11 Preparation of hot service water**
 - 1.11.1 Storage heaters
 - 1.11.2 Geysers
 - 1.11.3 Exchangers for heating of hot service water
- 1.12 Treatment of water for heating**

PIPES AND PIPE FITTINGS FOR HEATING, WATER, DRAINAGE, GAS AND STEAM

- 2.1 Pipes and systems**
 - 2.1.1 Copper distribution lines
 - 2.1.2 Steel distribution lines
 - 2.1.3 Plastic distribution lines
 - 2.1.4 Stainless distribution lines
 - 2.1.5 Pre-insulated distribution lines
 - 2.1.6 Connecting hoses
 - 2.1.7 Universal fittings
 - 2.1.8 Drains, sifons technics
 - 2.1.9 Other piping systems
- 2.2 Mounting equipment, pipe covers**
- 2.3 Pipe fittings for heating, water, gas and steam**
 - 2.3.1 Closing fittings
 - 2.3.2 Regulation fittings
 - 2.3.3 Other fittings

VENTILATION EQUIPMENT, AIR-CONDITIONING AND PROTECTION OF ATMOSPHERE

- 3.1 Air-conditioning of small areas
- 3.2 Air-conditioning of large areas

- 3.3 Ventilation and heating of industrial buildings
- 3.4 Air replacement with heat recovery
- 3.5 Drying and humidification of air
- 3.6 Air-conditioning of clean areas
- 3.7 Air pipelines- ventilation and air-conditioning systems
- 3.8 Treatment of air - filtration, heating, cooling, humidification and mixing
- 3.9 Ventilators
- 3.10 Steam extractors - industrial
- 3.11 Steam extractors - kitchen
- 3.12 Elements for air-conditioning pipelines
- 3.13 Separation, filtration, protection of atmosphere
- 3.14 Central vacuum cleaners

COOLING

- 4.1 Fixed cooling and refrigeration devices
- 4.2 Mobile cooling and refrigeration devices
- 4.3 Cooling towers
- 4.4 Heat-cold exchangers
- 4.5 Cool accumulators
- 4.6 Accessories for cooling
- 4.7 Unconventional sources of cooling

MEDICAL EQUIPMENT AND FITTINGS

- 5.1 Bathroom and WC fittings
- 5.2 Kitchen and large-kitchen fittings
- 5.3 Swimming pools, whirlpools, saunas, solaria and infra-red cabins
- 5.4 Sanitary units and pre-fabricated systems
- 5.5 Mixer taps
- 5.6 Sanitary pipe fittings
- 5.7 Equipment for the physically handicapped
- 5.8 Irrigation, drainage, use of rain water, fountains
- 5.9 Collection, treatment and cleaning of waste water
- 5.10 Filtration and treatment of drinking and service water
- 5.11 UV water disinfection

MEASURING, MANAGEMENT AND CONTROL

- 6.1 Regulators for heating
- 6.2 Regulators for ventilation
- 6.3 Regulators for cooling
- 6.4 Monitoring and control systems (DDC, CI etc.)
- 6.5 Regulators for original equipment manufacturer (OEM)
- 6.6 Regulation fittings and drives
- 6.7 Regulation items (sensors, cells, circuits, transducers, thermostats etc.)
- 6.8 Meters for heat energy and meters for allocation for heating costs
- 6.9 Water meters
- 6.10 Thermometers and pressure gauges
- 6.11 Gas flow meters - gas meters
- 6.12 Fluid level meters
- 6.13 Analysers and detectors

EQUIPMENT FOR GENERATION OF ELECTRICITY

- 7.1 Photovoltaic panels
- 7.2 Wind power stations
- 7.3 Small hydroelectric power stations
- 7.4 Cogeneration units

THERMAL INSULATION

- 8.1 Insulation materials
- 8.2 Construction insulation
- 8.3 Pipeline insulation
- 8.4 Insulation of fittings
- 8.5 Insulation of vessels
- 8.6 Insulation of energy machinery

TOOLS AND AIDS

- 9.1 Installation and service tools and equipment
- 9.2 Installation and service machines and accessories
- 9.3 Installation and service protective equipment
- 9.4 Software for operation and service

CONSULTATION, AUDITS, FINANCING, EDUCATION

- 10.1 Consultation-energy saving
- 10.2 Consultation-renewable sources of energy
- 10.3 Energy audits and economic evaluation of investments into energy
- 10.4 Financing of projects - banks, state support, EPC etc.

- 10.5 Software and internet
- 10.6 Consultation and publication activity for installation, maintenance and operation
- 10.7 Policy in energy industry
- 10.8 Testing and measurement
- 10.9 Training and education
- 10.10 Organising exhibitions, conferences etc.
- 10.11 Publishing magazines
- 10.12 Publishing specialist literature
- 10.13 Schools, training colleges and state institutions
- 10.14 Federations, guilds, associations and unions

PROJECT WORK

- 11.1 Project work-heating for houses and flats
- 11.2 Project work-large boilers and water distribution networks
- 11.3 Project work-alternative and renewable sources
- 11.4 Project work-water distribution networks and heating of hot water
- 11.5 Project work-ventilation and air-conditioning
- 11.6 Project work-gas distribution networks
- 11.7 Project work-measuring and regulation
- 11.8 Project work-power wiring
- 11.9 Project work-weak-current wiring
- 11.10 Project work-piping network
- 11.11 Project work-waste water, sewerage

INSTALLATION AND MAINTENANCE

- 12.1 Installation and maintenance of heating equipment
- 12.2 Installation of alternative and renewable sources
- 12.3 Installation and maintenance of ventilation and air-conditioning
- 12.4 Installation and maintenance of cooling devices
- 12.5 Installation of internal distribution networks for water and waste water
- 12.6 Installation of internal gas distribution networks
- 12.7 Construction of external heat networks
- 12.8 Construction of underground water pipes
- 12.9 Construction of underground sewerage networks
- 12.10 Construction of gas pipelines
- 12.11 Installation and maintenance of measuring and regulation
- 12.12 Installation of thermal insulation

WHOLESALE AND VENDORS

- 13.1 Wholesale-heating, water, gas
- 13.2 Wholesale-ventilation, air-conditioning
- 13.3 Wholesale-cooling equipment
- 13.4 Wholesale-medical and sanitary equipment, investment articles
- 13.5 Wholesale-measuring and regulation
- 13.6 Wholesale-thermal insulation
- 13.7 Wholesale-tools and working aids

OPERATION, INSPECTIONS, AUDITS

- 14.1 Emergency service
- 14.2 Operation-boiler rooms, transfer stations etc.
- 14.3 Audits-gas
- 14.4 Audits-boilers, boiler rooms
- 14.5 Audits-pressure vessels
- 14.6 Audits-chimneys

FACILITY MANAGEMENT

- 15.1 Management elements
- 15.2 Management of the technological infrastructure of buildings
- 15.3 Operation and revitalization of the technological infrastructure of buildings
- 15.4 Information/communication technology
- 15.5 Building/home automation
- 15.6 Warehouse management
- 15.7 Outsourcing
- 15.8 Consulting
- 15.9 Maintenance

OTHER SERVICES

- 16.1 Suppliers of fuel and energy**
 - 16.1.1 Suppliers of thermal energy
 - 16.1.2 Suppliers of gas
 - 16.1.3 Suppliers of electricity
 - 16.1.4 Suppliers of heating oils
 - 16.1.5 Suppliers of liquid gas (propane)
 - 16.1.6 Suppliers of wood, pellets and briquettes
 - 16.1.7 Suppliers of coal and coke
- 16.2 Transport services**

IMPLEMENTATION OF YOUR EXPOSITION

EXHIBITOR

P R A H A
aqua-therm
INTERNATIONAL

developed by  Reed Exhibitions
Messe Wien

23. - 27. 11. 2010

This entry send to: Progres Partners Advertising, s. r. o, Opletalova 55, CZ-110 00 Praha 1
tel.: +420/224 234 274, 224 218 403, fax: +420/224 235 033, 224 218 312, e-mail: aqua@ppa.cz

We would like to present you with a standard offer for stand implementation based on the Octanorm system, which can be further tailored to your needs in terms of the dimensions and type of exposition.

Applications sent by May 31st will be granted with 10% reduction from the base prices.

TYPE A

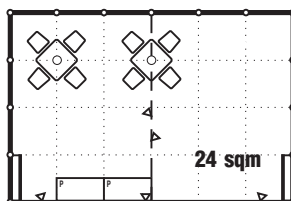
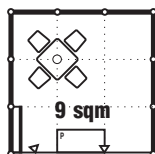
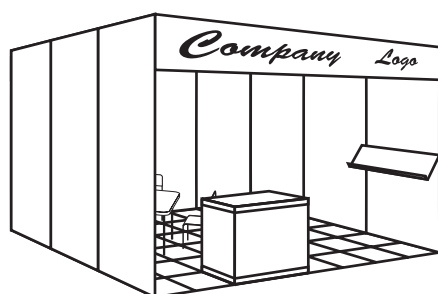

Exhibition stand includes: Aluminium frame, white walls, carpet according to your choice, lettering frame white 0,30 or 0,35 m height, lettering

| | 9 - 24 sqm | 25 - 48 sqm |
|---------------------------------|------------|-------------|
| Shelves | 1 - 2 | 2 - 4 |
| Table area (1 table, 4 chairs) | 1 - 2 | 2 - 3 |
| Infodesk | 1 | 2 |
| Spot 100 W (including grid)* | 4 - 8 | 6 - 14 |
| Sockets (including grid)* | 1 - 2 | 2 - 4 |
| Daily clean-up (excl. exhibits) | | |

* Need to order separately power supply

Price 1.450 CZK/sqm

excl. VAT

TYPE B

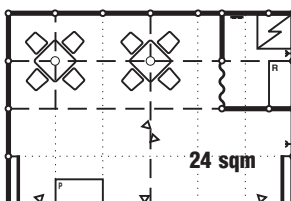
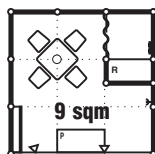
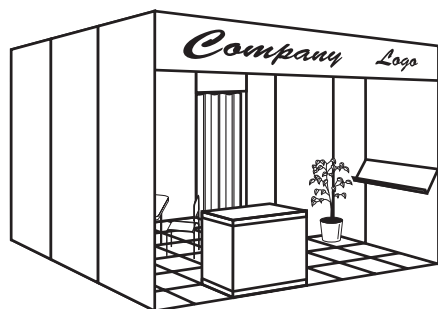

Exhibition stand includes: Aluminium frame, white walls, carpet according to your choice, latticed ceiling - Partly, storage cubicle (lockable folding door from 12 sqm), curtain, storage unit, coat rack, lettering frame white 0,30 or 0,35 m height, lettering

| | 9 - 24 sqm | 25 - 48 sqm |
|---------------------------------|------------|-------------|
| Shelves | 1 - 2 | 4 |
| Table area (1 table, 4 chairs) | 1 - 2 | 2 - 3 |
| Infodesk | 1 | 2 |
| Spot 100 W (including grid)* | 4 - 8 | 6 - 14 |
| Sockets (including grid)* | 1 - 2 | 2 - 4 |
| Flowers | 1 | 2 |
| Fridge | - | 1 |
| Daily clean-up (excl. exhibits) | | |

* Need to order separately power supply

Price 1.650 CZK/sqm

excl. VAT

TYPE C

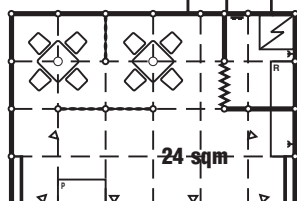

Dividing partitions will be dislocated according to your wish.

Exhibition stand includes: Aluminium frame, white walls, dividing partitions: panel or glass panel, latticed ceiling 1 x 1 m, carpet according to your choice, lettering frame white 0,30 or 0,35 m height, lettering, storage cubicle with lockable folding door, storage unit, coat rack, fridge, show case according to your choice

| | 12 - 24 sqm | 25 - 48 sqm |
|---------------------------------|-------------|-------------|
| Shelves | 1 - 2 | 2 |
| Table area (1 table, 4 chairs) | 1 - 2 | 2 - 3 |
| Infodesk | 1 | 2 |
| Spot 100 W (including grid)* | 4 - 8 | 7 - 15 |
| Sockets (including grid)* | 1 - 2 | 2 - 4 |
| Flowers | 1 | 2 |
| Daily clean-up (excl. exhibits) | | |

* Need to order separately power supply

Price 1.990 CZK/sqm



excl. VAT

Be not afraid to ask us about the installation of a non-standard exposition!

ADDITIONAL EQUIPMENT

(Available only in combination with the basic equipment, please check off the chosen items)

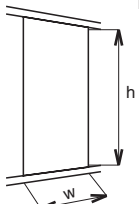
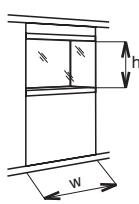
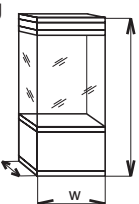
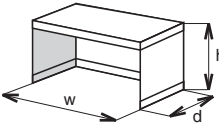
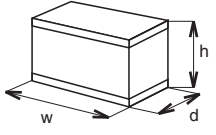
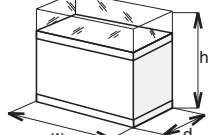
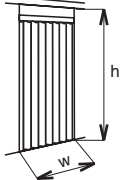
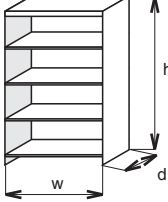
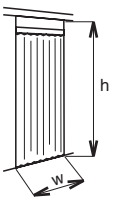
(w - width, h - height, d - depth)

| | | | |
|--|---|---|--|
| <p>Wall element</p> <p>w 1000 h 2500</p>  <p>900 CZK</p> <input type="checkbox"/> | <p>Built-in showcase</p> <p>w 1000 h 1100</p>  <p>2725 CZK</p> <input type="checkbox"/> | <p>Showcase with lighting</p> <p>w 1030 h 2500/2000 d 530</p>  <p>3825 CZK</p> <input type="checkbox"/> | |
| <p>Counter</p> <p>w 1030 h 860 d 530</p>  <p>1150 CZK</p> <input type="checkbox"/> | <p>Pedestal</p> <p>w 1030 h 400 d 530</p>  <p>1200 CZK</p> <input type="checkbox"/> | <p>Table showcase with cabinet corpus</p> <p>w 1030 h 900 d 530</p>  <p>2625 CZK</p> <input type="checkbox"/> | |
| <p>Locable folding door element</p>  <p>w 1000 h 2500</p> <p>2150 CZK</p> <input type="checkbox"/> | <p>Storage unit</p> <p>w 1030 h 2000 d 530</p>  <p>1225 CZK</p> <input type="checkbox"/> | <p>Curtain</p> <p>w 1000 h 2500</p>  <p>800 CZK</p> <input type="checkbox"/> | |
| <p>Table</p> <p>w 800 h 720 d 800</p>  <p>500 CZK</p> <input type="checkbox"/> | <p>Chair</p>  <p>300 CZK</p> <input type="checkbox"/> | <p>Bar chair</p> <p>800 CZK</p> <input type="checkbox"/> | |
| <p>Refrigerator</p> <p>1975 CZK</p> <input type="checkbox"/> | <p>Socket</p> <p>430 CZK</p> <input type="checkbox"/> | <p>Spot 100 W</p> <p>450 CZK</p> <input type="checkbox"/> | |
| <p>Sink, Water geiser</p> <p>3960 CZK</p> <input type="checkbox"/> | <p>Ceiling raster 1 m x 1 m</p> <p>250 CZK</p> <input type="checkbox"/> | <p>POWER SUPPLY incl. power consumption:</p> <p><input type="checkbox"/> 2 kW / 230 V 4.890 CZK</p> <p><input type="checkbox"/> 3 kW / 230 V 5.760 CZK</p> <p><input type="checkbox"/> 5 kW / 230 V 7.080 CZK</p> <p><input type="checkbox"/> 6 kW / 230 V 8.245 CZK</p> | |
| <p>The prices are given for one item for the entire period of the exhibition. Prices are without VAT</p> | | | <p>(These prices do not include 20% VAT)</p> |

WE ORDER A COMPLETE STAND

These prices do not include VAT.

TYPE A: sqm (1.450 CZK/sqm) **TYPE B:** sqm (1.650 CZK/sqm) **TYPE C:** sqm (1.990 CZK/sqm)

Required text to be marked on the stand:

.....

.....

Required colour of carpet:

.....

Place and date

.....

Company stamp and legally binding signature